



1MORE ES303 Wireless Earbuds User Guide

February 18, 2022 February 24, 2022 [Leave a comment](#)

[Home](#) » [1more](#) » 1MORE ES303 Wireless Earbuds User Guide 📄

1MORE ES303 Wireless Earbuds



Contents [\[hide](#)

- [1 In The Box](#)
- [2 Placement](#)
- [3 1MORE MUSIC APP](#)
- [4 Power](#)
- [5 Headphones Pairing](#)
- [6 Bluetooth Pairing to The Device](#)
- [7 Charging Methods](#)
- [8 Battery Status Display in 1MORE MUSIC APP](#)
- [9 Battery Notification](#)
- [10 Touch Controls](#)
- [11 Smart Playback](#)
- [12 Other Functions](#)
- [13 1 MORE \(1\) Year Limited Warranty](#)
- [14 We Appreciate Your Business](#)
- [15 Tips](#)
- [16 Safety Information](#)
- [17 FAQ](#)
- [18 WEEE](#)
- [19 Safety Caution](#)
- [20 CE](#)
- [21 FCC](#)
- [22 Documents / Resources](#)
 - [22.1 Related Manuals / Resources](#)

In The Box

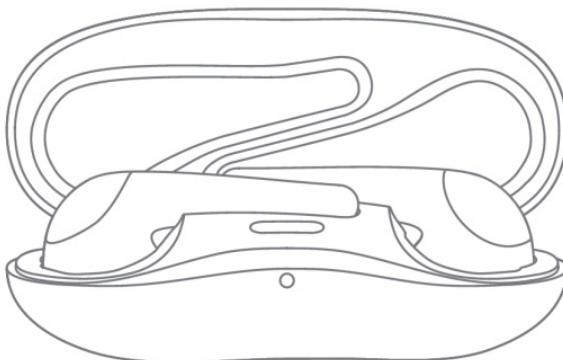

Charging Case x 1

Earbuds x 1 Pair

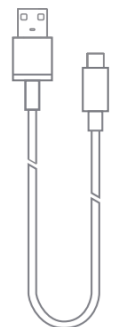

Type-C Charge

Placement

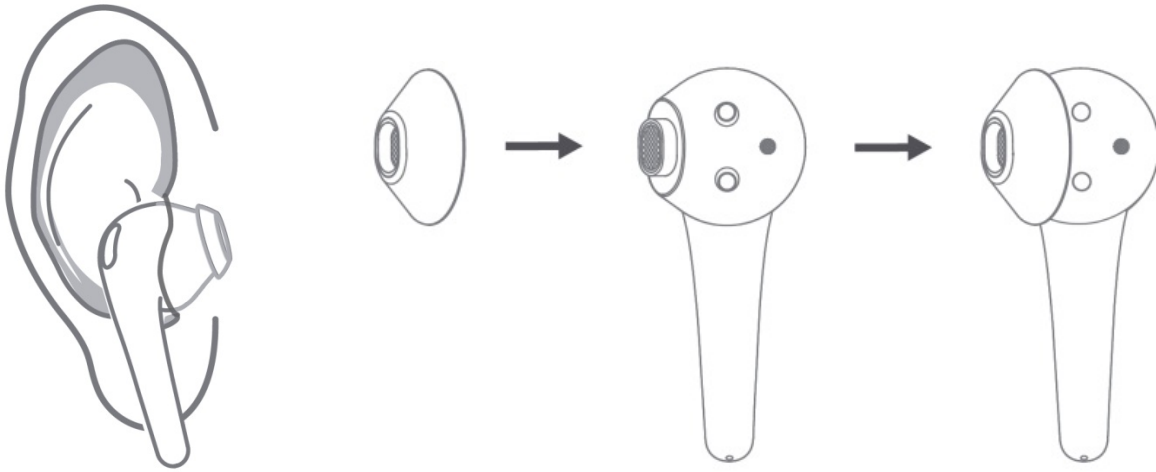

* To ensure the snug wearing, choose the fit ear tips.

1MORE MUSIC APP



For users outside mainland China, please download the 1MORE MUSIC APP for product upgrades and additional features.

Power

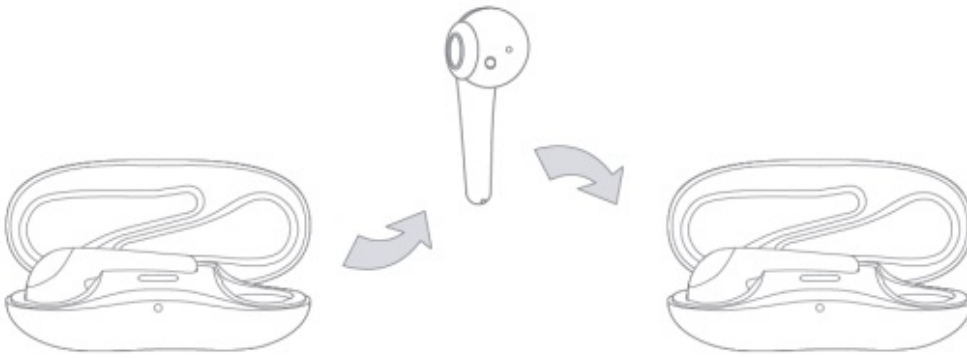

Power On: Open the charging case, the earbuds will turn on automatically.

Power Off: Put the earbuds back into the charging case and close the lid, they will automatically turn off and start charging.

* Above functions are available for either earbud in Mono or Stereo mode.

Headphones Pairing

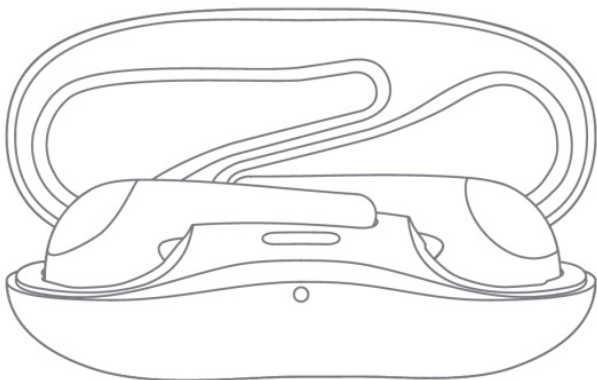

The left/right earbud will automatically pair once the lid opens when they stay in the case.

Bluetooth Pairing To The Device

1. The first time you turn on the headphones, they will automatically enter pairing mode. Headphones will turn off if not paired to any device within 3 minutes.
2. After the first successful pairing, headphones will automatically connect to the last connected device.
3. To pair with a new device: When not in a call, press and hold the pairing button for 8 seconds to clear connection history and then re-enter pairing mode.

* Above functions are available for either earbud in Mono or Stereo mode.

Charging Methods

- Use Type-C cable to charge the case, a full charge will take around 80 minutes. The green LED on the charging case indicates the case is fully charged.

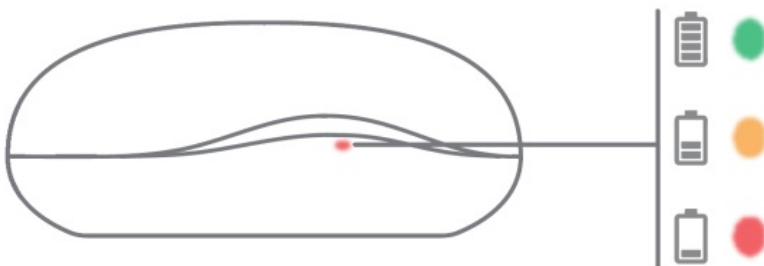

- To charge the earbuds with the charging case. A full charge will take around 40 minutes. When fully charged, the LED indicator will turn off.

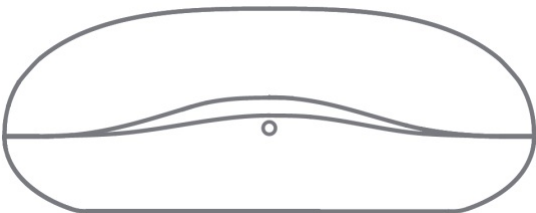

Battery Status Display in 1MORE MUSIC APP

Battery status of headphones and charging case will be display in 1MORE APP.

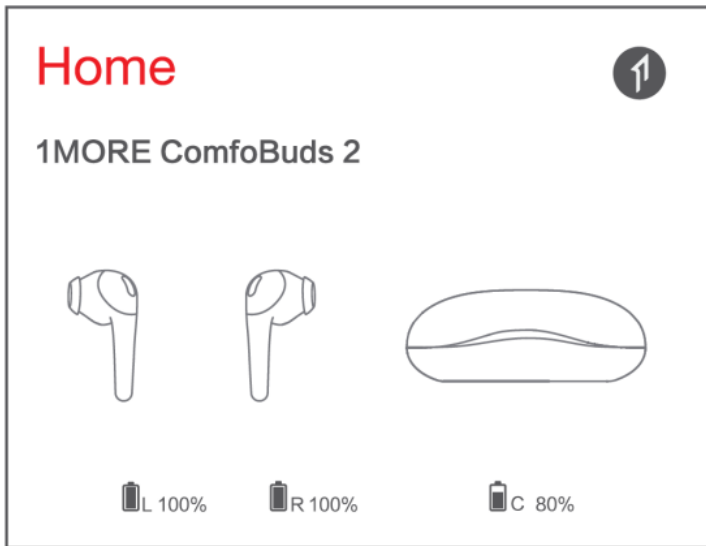

Battery Notification

Low Battery Warning: When there is 25-30 minutes of use time left, you will hear a voice prompt.



Low Battery Warning: When there is 25-30 minutes of use time left, you will hear a voice prompt.

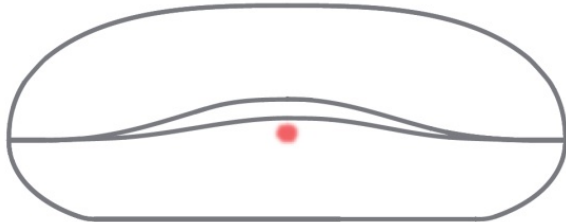

Touch Controls

Tap the touch control area of the earbuds to control phone calls and music playback.

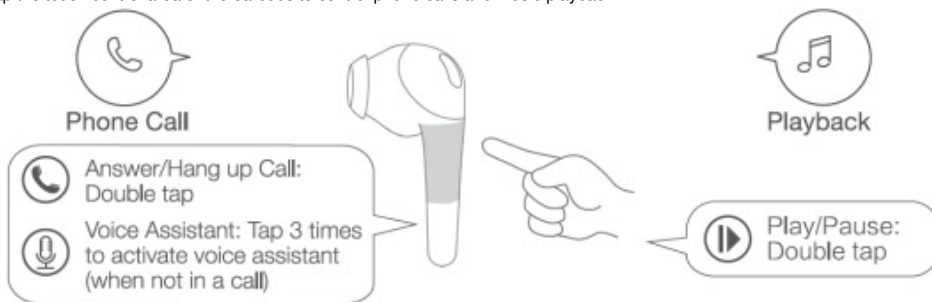

- To reject a call, please operate on the connected mobile phone
- To control the music playback or volume adjustment, please set it up on 1 MORE MUSIC APP or operate on the connected mobile phone or devices.
- Above functions are available for either earbud in Mono or Stereo mode.
- Above functions may vary with different devices.

Smart Playback

Automatically pause music when taking out your earbuds, and resume once you put them back on. Smart Playback can be turned off via 1 MORE MUSIC APP.

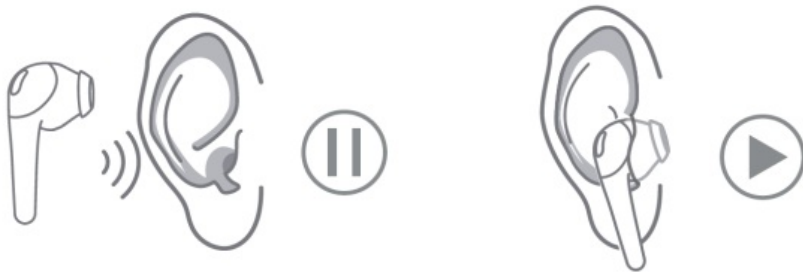

Other Functions

1. If the earbuds cannot pair normally when powered on, open the case and quickly click the pairing button 3 times to reset the Left & Right pairing process.
2. Unpair the Connected Device:
Put the earbuds into the case, press and hold the pairing button for 8 seconds.
3. OTA Firmware Update:
It can be synchronously upgraded via 1 MORE MUSIC app when the earbuds are connected.
* Functions of 1 MORE MUSIC APP may vary with different devices or operating systems.
For more details, please contact our customer service.

1 MORE (1) Year Limited Warranty

1MORE warrants to the original retail purchaser that this product is to be free from defective materials and workmanship for a period of one year from the date of purchase if it is properly used and maintained. If this product proves defective in either material or workmanship, 1MORE, at its option, will (a) repair the product with new or refurbished parts, or (b) replace the product with an equivalent new or refurbished product, at no charge for parts or labor. If the product model is no longer available and cannot be repaired effectively or replaced with an identical model, 1 MORE at its sole option may replace the unit with a current model of equal or greater value. In some cases, modification to the mounting surface may be required where a new model is substituted. 1 MORE assumes no responsibility or liability for such modification.

TO OBTAIN A REPAIR OR REPLACEMENT UNDER THE TERMS OF THIS WARRANTY, PLEASE RETURN TO THE ORIGINAL DEALER FIRST AND THE ORIGINAL DEALER SHALL REPAIR THE PRODUCT WITH NEW OR REBURNISHED PARTS OR REPLACE THE PRODUCT WITH AN EQUIVALENT NEW OR REBURNISHED PRODUCT.

You will be required to submit a proof of purchasing details, including but not limited to a receipt or sales invoice.

Return shipping for exchanges/repairs is the sole responsibility of the original retail purchaser.

Limitations:

- This limited warranty does not cover the failure of the product resulting from improper installation, misuse, abuse, accident, neglect, mishandling, or wear from ordinary use or environmental deterioration.
- This limited warranty does not cover cosmetic damage, including paint damage, or consequential damage to other components or premises which may result for any reason from the failure of the product.
- This limited warranty is null and void for products not used in accordance with 1MORE's instructions.
- This limited warranty is null and void for products with altered or missing serial numbers and for products not purchased from an AUTHORIZED dealer.
- This limited warranty terminates if you sell or otherwise transfer this product to another party.

We Appreciate Your Business

We know you will enjoy new 1MORE headphones as much as we do. At 1 MORE, we value your satisfaction. If you would like more details on this product or any of our other products, please visit us online by scanning the QR code. Go to www.1more.com and sign up for VIP, and 1MORE will treat you like one.

Tips

1. Please read this instruction manual carefully and retain for future reference.
2. Please fully charge the battery before first use.
3. If the headphones have been unused for more than 3 months, we recommend that you charge them. This will improve battery capacity.
4. Only use charging cables and adapters that are FCC (Federal Communications Commission) approved.
5. In dry environments, static electricity may numb your ear. This is not related to the quality of the product.

Safety Information

1. Never disassemble the headphones. There are no user-serviceable parts inside.
2. Do not expose the headphones to temperatures below 32 °F (0 °C) or to temperatures above 113 °F (45 °C).
3. Do not use the headphones in a thunderstorm storm. This could prevent the headphones from working properly, and also increase your chance of being electrically shocked.
4. Do not use oil or any volatile liquid to clean this product.
5. Do not listen at high volumes for extended periods of time.
6. Do not use the headphones in traffic. Do not use the headphones any time it would be dangerous to be unaware of noises around you.
7. Adult supervision is required for children of age 6 and under.

FAQ

1. Why the headphones cannot be turned on?
Check if your headphones have enough battery life. If not, please charge them for at least 30 minutes.
2. Why the headphones cannot connect to my cellphone, or take a long time to connect?
1) If the earbuds cannot pair to one another, and only one earbud will pair with your cellphone, then put both buds back into the charging case and quickly press the pairing button 3 times, click the device name, they should now pair correctly to the phone.
2) To pair the earbuds to a new cellphone, simply place them into the charging case and depress the pairing button for 3 seconds. Then click the new device name and pair with the new cellphone.
3. Why the headphones cannot play music after successfully connecting to my Android device?
After pairing successfully, on the Bluetooth menu of your device, tap the icon on the right of your device name and make sure the "Media Audio" option is on.
4. Why there is no sound from the headphones while making phone calls after successfully connecting to my Android device?
After pairing successfully, on the Bluetooth menu of your device, tap the icon on the right of your device name and make sure the "Phone Audio" option is on.
5. Why the Bluetooth connection is not stable and causes some interruptions?
1) Try shortening the distance between your headphones and device. Avoid solid barriers in between.
2) Please keep away from strong interference sources, such as Wi-Fi and GPRS.
3) Please make sure the Bluetooth antenna of your device is not blocked.
6. Why some control functions do not match those in the manual while using third party music/video player Apps?
Your operating system and the third party music/video player apps may have different settings for the in-line remote control functions. We recommend that you use the music/video player apps that your device has originally provided.
7. I turned the headphones up to the maximum volume, but why the actual volume still sounds low?
In different operating systems, especially some Android systems, the headphones and your device have separate volume control systems. Please adjust the volume controls on both the device and the headphones according to your preference.
8. Why are my headphones not able to connect to 1 MORE MUSIC APP for the primary use?

For Android users, please click "Allow all the time" to access to the location information of your device when entering 1MORE MUSIC APP. Or adjust this option in your settings for this app.

* For more detailed product FAQs, please visit the product support section under www.1more.com

WEEE

Electrical and electronic equipment, parts and batteries marked with this symbol must not be disposed of with normal household waste, it must be collected and disposed of separately to protect the environment.

Your 1 MORE retailer will advise you of the correct way of disposal in your country

Safety Caution

Do not expose batteries or battery packs to excessive heat such as sunshine, fire or the like.

CE

Declaration of Conformity Hereby, Tiinlab Acoustic Technology Limited declares that the radio equipment type 1 MORE ComfoBuds 2 Wireless Headphones of ES303 is in compliance with Directive 2014/53/EU.

The full text of the EU declaration of conformity is available at the following internet address: www.1more.com

EU regulatory conformance:

RF exposure information: The EIRP power of the device at maximal case is below the exempt condition, 20mW specified in EN62479: 2010.

RF exposure assessment has been performed to prove that this unit will not generate the harmful EM emission above the reference level as specified in EC Council Recommendation(1999/519/EC)

Declaration for EU Compliance

Operation Frequency/Max. EIRP: 2402-2480MHz, 10 dBm

Warning

Replacement of a battery with an incorrect type that can defeat a safeguard (such as catching fire, explosion, leakage of corrosive electrolyte etc);

Disposal of a battery into fire or a hot oven, or mechanically crushing or cutting of a battery, that can result in an explosion;

Leaving a battery in an extremely high temperature surrounding environment that can result in an explosion or the leakage of flammable liquid or gas; and A battery subjected to extremely low air pressure that may result in an explosion or the leakage of flammable liquid or gas.

The symbol indicates DC voltage.



RECYCLING

This product bears the selective sorting symbol for Waste electrical and electronic equipment (WEEE).

This means that this product must be handled pursuant to European directive 2014/53/EU in order to be recycled or dismantled to minimize its impact on the environment.

User has the choice to give his product to a competent recycling organization or to the retailer when he buys a new electrical or electronic equipment.



To prevent possible hearing damage, do not listen at high volume levels for long periods.

FCC

The device has been evaluated to meet general RF exposure requirement, The device can be used in portable exposure condition without restriction. Federal Communication Commission (FCC) Radiation Exposure Statement Power is so low that no RF exposure calculation is needed.

This device complies with part 15 of the FCC rules. Operation is subject to the following two conditions:

(1) this device may not cause harmful interference, and (2) this device must accept any interference received, including interference that may cause undesired operation.

NOTE: The manufacturer is not responsible for any radio or TV interference caused by unauthorized modifications or changes to this equipment. Such modifications or changes could void the user's authority to operate the equipment.

NOTE: This equipment has been tested and found to comply with the limits for a Class B digital device, pursuant to part 15 of the FCC Rules. These limits are designed to provide reasonable protection against harmful interference in a residential installation. This equipment generates uses and can radiate radio frequency energy and, if not installed and used in accordance with the instructions, may cause harmful interference to radio communications. However, there is no guarantee that interference will not occur in a particular installation. If this equipment does cause harmful interference to radio or television reception, which can be determined by turning the equipment off and on, the user is encouraged to try to correct the interference by one or more of the following measures:

- Reorient or relocate the receiving antenna.
- Increase the separation between the equipment and receiver.
- Connect the equipment into an outlet on a circuit different from that to which the receiver is connected.
- Consult the dealer or an experienced radio/TV technician for help.

Supplier's Declaration of Conformity

47 CFR § 2.1077 Compliance Information

Unique Identifier:

Trade Name: 1 MORE

Model No.: ES303

Responsible Party- U.S. Contact Information 1 MORE USA, Inc.

Address: 10225 Barnes Canyon Road, Suite A202, San Diego, California, 92121

Tel: 1 -855-551-6673

E-Mail: support@1moreusa.com

The SAR limit of USA (FCC) is 1.6 W/kg for head averaged over one gram of tissue. Device types ES303 (FCC ID: 2ASDIES303-R, FCC ID: 2ASDIES303-L) has also been tested with 0mm against this SAR limit.

Wireless Headphones

Battery Life

Model: ES303

* Headphones fully charged

Headphone Weight (Single): 4.3 g

Playback Time: 6 hours*

Case Weight: 26.9 g

* Headphones and case fully charged

Product Weight: 36.5 g

Playback Time: 24 hours*

Headphone Size: 39.36 x 17.96 x 19.2 mm

Impedance: 28 Ω

Case Size: 68.8 x 30 x 26.4 mm

Wireless Range: 10 m

Headphone Battery Capacity (Single): 43 mAh

Bluetooth: Bluetooth® 5.0

Case Battery Capacity: 410 mAh

Bluetooth Protocol: HFP / A2DP / AVRCP

Headphone Charging Time: Approx. 40 mins

Input: 5V 0.5A

Case Charging Time: Approx. 80 mins

Working Temperature: 0 °C ~ 45 °C
Frequency Band: 2.400 GHz~ 2.4835 GHz

The specifications are acquired from laboratory tested data.

** The playback time, tested under the laboratory condition of AAC format and 50% volume, may vary with different device setting, environments, usage and other factors.*

Manufacturer: Tiinlab Corporation

Address: No. 3333, Liuxian Avenue, Tower A, 35th Floor, Tanglang City,
Nanshan District, Shenzhen, China

Product information can be found at www.1more.com

Made in China



www.1more.com

Manufacturer: Tiinlab Corporation

Add: No. 3333, Liuxian Avenue, Tower A, 35th Floor, Tanglang City, Nanshan District, Shenzhen, China



FCC ID: 2ASDIES303-L

FCC ID: 2ASDIES303-R

CMIIT ID: 2021DP7881



1MORE

Documents / Resources



[1MORE ES303 Wireless Earbuds \[pdf\] User Guide](#)
ES303 Wireless Earbuds, ES303, Wireless Earbuds

Related Manuals / Resources



[FiiTii i2 Wireless Earbuds User Guide](#)

FiiTii i2 Wireless Earbuds PRODUCT ILLUSTRATION When the headset and mobile device is under connecting status ,if did...

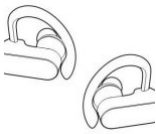

[True Wireless Earbuds User Manual](#)

True Wireless Earbuds User Manual



[adidas 01 ANC Wireless Earbuds User Guide](#)

QUICK START GUIDE www.adidasheadphones.com OPEN THE CHARGING CASE PRESS AND HOLD THE LOGO ON THE FRONT OF THE...

[MPOW Mini Wireless Earbuds User Guide](#)

• DREAM • EXPLORE • INSPIRE MPOW EM16 MINI WIRELESS HEADSET MPOW AUDIO WIRELESS Pair Mode 1: Auto...

Leave a comment

Your email address will not be published.

Comment

Name

Email

Website

Save my name, email, and website in this browser for the next time I comment.

[Manuals+](#)

- [home](#)
- [privacy](#)